

450-3320 Swage Mount Socket, for .040 (1,02) Diameter Pins.

Recommended mounting hole .094 (2,39) ±.002 (0,05), #42 drill

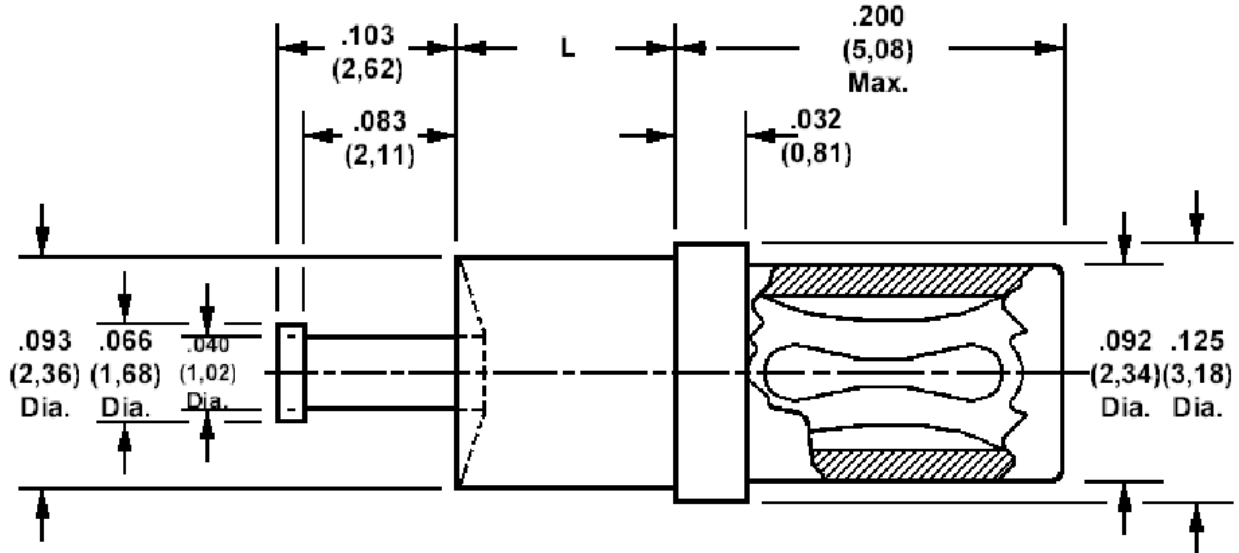

Min hole depth .190 (4,83)

How to order code
450-3320-YY-XX-00

Basic Part No YY = Board thickness XX = Finish

| DIMENSIONS | | |
|--------------|-------------|-----------------|
| Dash No (YY) | 'L' | Board Thickness |
| -01 | .062 (1,57) | .031 (0,79) |
| -02 | .094 (2,39) | .062 (1,57) |
| -03 | .125 (3,18) | .094 (2,39) |
| -04 | .156 (3,96) | .125 (3,18) |
| -05 | .219 (5,56) | .188 (4,76) |

| MATERIALS | | | | |
|-----------|------------------|------------------|--------------|------------------|
| Component | Material | Finish (-03) | Finish (-04) | Finish (-06) |
| Body | Brass | Gold over Nickel | Electro Tin | Electro Tin |
| Spring | Beryllium copper | Gold over Nickel | Electro Tin | Gold over Nickel |

| TOOLING | |
|-----------------------------|-------------------|
| Recommended Swaging Tools:- | |
| Anvil | 435-6404-01-00-00 |
| Roll Punch | 435-6658-02-00-00 |